

B125, B150, B300 Basket Strainer

Design Features :



- Standard sizes from 2"-24". Larger sizes available.
- Available with RF For RTJ flanged (ASME B16.5) or Butt weld (ASME B16.9) end connections.
- Standard thru bolt cover design.
- Custom designs are available.
- Perforated screens are standard.
- May be installed in horizontal pipelines.
- Strainers to meet there quirements of ASME B16.34, B31.3 and/or ASME Section VIII, Div.I.
- Drain is standard and is complete with plug.
- Vents, differentials and special covers are optional

Working Pressure & Temperature

DN50 - DN600	PN10, PN16 / Class 125
DN50 - DN300	PN25 / Class 250
Temperature form	- 10°C to 120°C

Flange Type

EN1092-2 PN10/PN16/PN25, ANSI B16.5, Class 125, Class 250, BS10 Table D/E, JIS 10K / 16K

Standard Screens		
Size	Hole Diameter	Free Flow Area
DN50 - DN80	1.5 mm	33%
DN100 - DN600	3.0 mm	40%

Materials		
Part	Material	EN Spec
Body	Cast Iron	EN-JL 1040
	Ductile Iron	EN-JS 1050
Cover	Cast Iron	EN-JL 1040
	Ductile Iron	EN-JS 1050
Screen	Stainless Steel	SS304 / SS316
Gasket	EPDM	EPDM
Plug	Cast Iron	EN-JL 1040
	Ductile Iron	EN-JS 1050

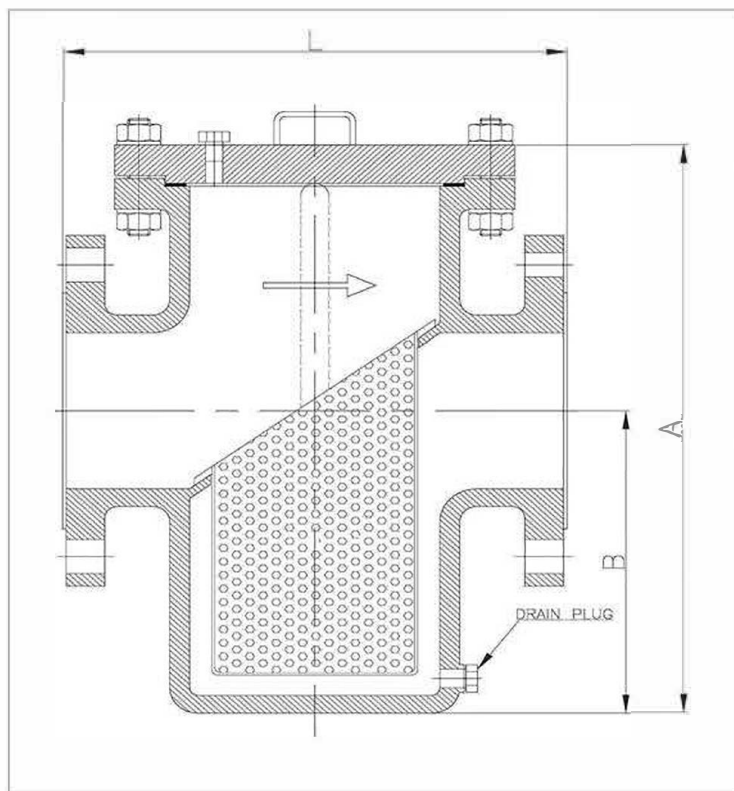

Size	40	50	80	100	150	200	250	300	350	400	450	500	600
L	210	240	265	300	400	550	625	670	770	840	900	950	1050
A	245	275	340	375	600	775	875	990	1050	1125	1175	1375	1500
B	130	150	175	185	375	500	550	600	625	700	750	825	900
Plug	1/2"	1/2"	1/2"	3/4"	3/4"	1"	1"	1 1/2"	1 1/2"	1 1/2"	2"	2"	2"
Weight kgs.	20	28	40	60	130	180	235	360	480	1100	1300	1500	1950